

# SIAMP 49 Dual Flushing Valve

## Fault Finding Guide

### Troubleshooting: Dual Flush Valve Not Flushing



- 1 - Push Button inc Execution
- 2 - Upper Piston
- 3 - Adjustable Stirrup
- 4 - Valve Gasket
- 5 - Strainer
- 6 - Strainer Seal

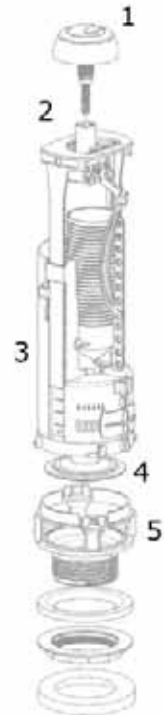

1. Turn off the water supply
2. Remove Push Button
3. Insert a slim object (similar to a pen) into the Upper Piston (2), if this then flushes, the valve is working fine and therefore a new push button may be required.
4. The Valve Assembly is connected to the Strainer on a bayonet fitment to remove rotate the Valve Assembly Anti-Clockwise away from the Strainer (5).
5. Remove the Valve Assembly from the cistern.
6. Check Valve Settings (*Fig 1.1*)
7. Replace the Valve Assembly back in the Strainer (5) by reversing the removal process.

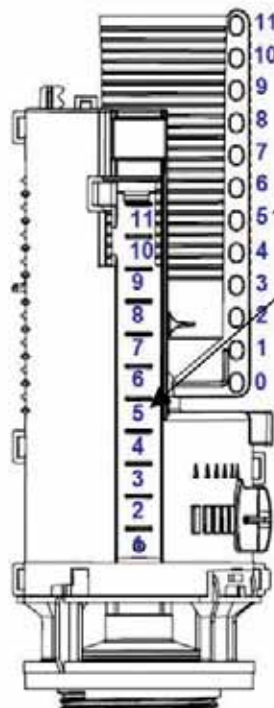

*Fig 1.1*

Please ensure the settings on the Overflow Tube (2) and the Adjustable Stirrup (3) are set at the same number.

If the problem still persists spare parts may be purchased, if this is the case then these can be obtained on 0161 205 1200 quoting your Purchase Order Number.

**PLEASE NOTE: Parts may be chargeable.**